

Technical Data Sheet

Plum Eyewash 0.9% Sodium Chloride

1. Identification of the product and the company

1.1. Product identifier and intended use.

Trade Name:	Plum Eyewash 0.9% Sodium Chloride and Plum Eyewash 0.9% Sodium Chloride QuickRinse
Intended Use:	The products are intended to be used as first aid products for eye irrigation.
Expiry date:	Printed on the bottle label/ampoule.

1.2. Details of the supplier of the data sheet

Manufacturer	
Company:	Plum A/S
Address:	Frederik Plums Vej 2
Zip code:	5610
City:	Assens
Country	DENMARK
E-mail	info@plum.eu
Phone	+45 64712112
Fax	+45 64712125

1.3 Legislative information

General information:	<p>As the products are class 1s sterile medical devices according to <i>Council Directive 93/42/EEC of 14 June 1993 concerning medical devices</i>, they are certified by the Notified Body, Presafe. No Safety Data Sheet is required for medical devices.</p> <p>The products shall not be classified as hazardous according to the classification and labeling rules for substance and mixtures.</p> <p>Plum A/S is certified according to <i>ISO 13485:2016 Medical devices – Quality management systems – Requirements for regulatory purposes</i>.</p>
----------------------	--

1.4 Instruction for use:

Mono eye cup (200, 500, 1000 ml)

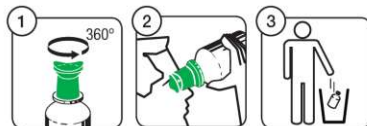

Duo eye cup (500, 1000 ml)



Ampoule (20 ml)

- Do not reuse.
- Do not use if damaged.
- Recommended temperature when used



Distributed by:



Technical Data Sheet

Plum Eyewash 0.9% Sodium Chloride

2. General information about the product

Material requirements:

The materials in these products have been judged biocompatible according to the requirements of *ISO 10993-1:2009 Biological evaluation of medical devices – Part 1: Evaluation and testing within a risk management process*.

Bottle, label and eye cup dimensions.

	20 ml ampoule	200 ml bottle	500 ml bottle	1000 ml bottle
Bottle material	Polyethylene without additives	Polyethylene without additives	Polyethylene without additives	Polyethylene without additives
The bottle/ampoule contains [ml]	20.0-20.5	201-207	505-512	1005-1020
Bottom Ø [mm]	21	58.5	78	90
Height [mm]	104	129.6	183	229

3. Side effects and malfunction

Side effects and malfunction:

The products are designed as a first aid product for eye irrigation. If side effects or malfunctions are experienced, please report these to Plum A/S, info@plum.eu or phone +45 6916 9600, so that necessary remedial measures can be initiated. Serious adverse effects should always be reported to a relevant competent authority.

4. Storage

Storage:



Shelf life:

42 months from manufacturing date.

Installation:

Please refer to the pictogram on the label:



Mounting stations and boxes:

Please visit <https://plum.eu/products/firstaid/eye-wash>

5. Other information

Version history and indication of changes

Version	Revision date	Responsible	Changes
1.2	30-09-2020	CL	5
1.1	03-06-2020	CL / VWB	5
1.0	14-04-2020	CL / VWB	

Other information

Additional information can be obtained by contacting info@plum.eu or by telephone +45 6916 9600

TDS prepared by:

Company: Plum Safety ApS
Address: Mandelalleen 1
Zip code: 5610
City: Assens
Country: DENMARK
E-mail: info@plum.eu
Phone: +45 6916 9600
Fax: +45 6471 2125

Document Language: English

Distributed by:



Technical Data Sheet

Plum Eyewash pH Neutral 4.9% Phosphate

1. Identification of the product and the company

1.1. Product identifier and intended use.

Trade Name:	Plum Eyewash pH Neutral 4.9% Phosphate
Intended Use:	The products are intended to be used as first aid products for eye irrigation after accidents involving acids and alkali.
Expiry date:	Printed on the bottle label.

1.2. Details of the supplier of the data sheet

Manufacturer	
Company:	Plum A/S
Address:	Frederik Plums Vej 2
Zip code:	5610
City:	Assens
Country:	DENMARK
E-mail:	info@plum.eu
Phone:	+45 64712112
Fax:	+45 64712125

Distributed by:



1.3 Legislative information

General information: As the products are class 1s sterile medical devices according to *Council Directive 93/42/EEC of 14 June 1993 concerning medical devices*, they are certified by Notified Body, Presafe. No Safety Data Sheet is required for medical devices.

The products shall not be classified as hazardous according to the classification and labeling rules for substance and mixtures.

Plum A/S is certified according to *ISO 13485:2016 Medical devices – Quality management systems – Requirements for regulatory purposes*.

1.4 Instructions for use:

Mono eye cup (200 and 500ml) / Shower eye cup (1000 ml)



DUO eye cup (500 ml)



- Always wash with Plum Eyewash 0.9% Sodium Chloride after using Plum Eyewash pH Neutral 4.9% Phosphate!
- Do not reuse.
- Do not use if damaged.
- Recommended temperature when used



Technical Data Sheet

Plum Eyewash pH Neutral 4.9% Phosphate

2. General information about the product

Material requirements: The materials in these products have been judged biocompatible according to the requirements of *ISO 10993-1:2009 Biological evaluation of medical devices – Part 1: Evaluation and testing within a risk management process*.

Bottle, label and eye cup dimensions.

	200 ml bottle	500 ml bottle	1000 ml bottle
Bottle material	Polyethylene without additives	Polyethylene without additives	Polyethylene without additives
The bottle contains [ml]	201-207	505-512	1005-1020
Bottom Ø [mm]	58.5	78	90
Height [mm]	129.6	183	229

3. Side effects and malfunction

Side effects and malfunction: The products are designed as a first aid product for eye irrigation. If side effects or malfunctions are experienced, please report these to Plum A/S, info@plum.eu or phone +45 6916 9600, so that necessary remedial measures can be initiated. Serious adverse effects should always be reported to a relevant and competent authority.

4. Storage

Storage:

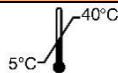

Shelf life:

42 months from manufacturing date.

Installation:

Please refer to the pictogram on the label:



Mounting stations and boxes:

Please visit <https://plum.eu/products/firstaid/eye-wash>

5. Other information

Version history and indication of changes

Version	Revision date	Responsible	Changes
1.2	30-09-2020	CL	5
1.1	03-06-2020	CL / VWB	3, 5
1.0	14-04-2020	CL /VWB	

Other information

Additional information can be obtained by contacting info@plum.eu or by telephone +45 6916 9600.

TDS prepared by:

Company: Plum Safety ApS
Address: Mandelalleen 1
Zip code: 5610
City: Assens
Country: DENMARK
E-mail: info@plum.eu
Phone: +45 6916 9600
Fax: +45 64712125

Document Language: English

Distributed by:

